

# DATASHEET - S2 ZIP ANCHOR

The product has been designed to provide a cost-effective, reliable and simple solution for holding down:

- ▶ High Performance Turf Reinforcement Matting
- ▶ Landfill Rain Covers
- ▶ Waste Containment
- ▶ High Density Polyethylene Liners
- ▶ Grass Pavers and Concrete Filled Cloth
- ▶ Landscaping Fabrics



The S2 Zip Anchor is a low cost anchor solution installed with simple hand tools which can be used in a wide range of soils with ultimate loads of up to 50kg / 100lbs.

The system's unique design incorporates our T-Loc technology with a simple cable tie style adaption to provide a self locking load plate. It's easy to use and offers a much better alternative to traditional pins which are unreliable and easily pulled out.



**SPECIFICATIONS**

**S2P Anchor:** 70mm x 26mm (2<sup>3</sup>/<sub>4</sub>" x 1"), 1500 mm<sup>2</sup> (2.32 inches<sup>2</sup>)

**Strap:** 500mm x 13mm (19" x 1/2")

**Load Plate:** 60mm x 9mm (2 1/2" x 3/8")

Ultimate Anchor System Load of 50kg / 100lbs

All materials are UV stabilised and highly corrosion resistant

**TOOLS REQUIRED**



Drive Rod



S2 Zip-Hook

OR



Setting Tool



Cutters

PDEA®, ARGES® and ARVS® are Registered Trademarks of Platipus Anchors.  
 Platipus Anchors technology is protected by International Patents, Trademarks and Registered Copyright.

# S2 ZIP ANCHOR INSTALLATION

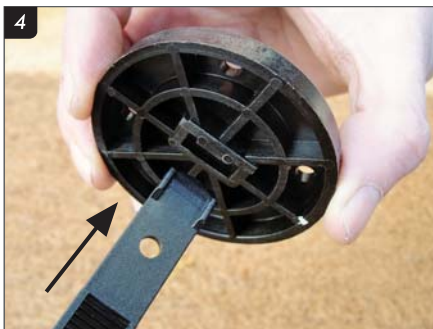
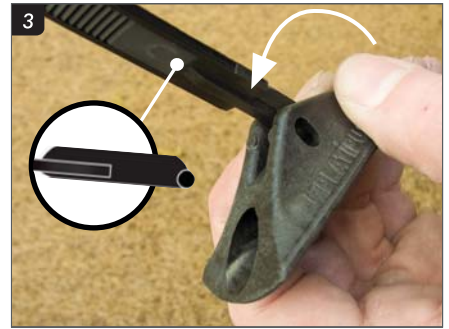
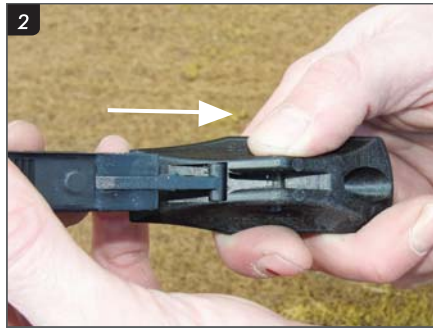

OR



PDEA®, ARGS® and ARVS® are Registered Trademarks of Platipus Anchors.  
Platipus Anchors technology is protected by International Patents, Trademarks and Registered Copyright.